

ENDEAVOUR

LINEAR HIGH BAY



407-478-3759
www.ilp-inc.com

FEATURES

- Sleek Curved Polycarbonate Injection Molded End Caps
- Aluminum Body with steel channel for added rigidity
- Toolless Hinged Driver Access
- Wide & Narrow Distributions
- Impact Resistant and IP5X Rated Lens Options:
 - Frosted Acrylic (FRL)
 - Frosted Polycarbonate (PFL) IK10 Impact Rated
- V-Clips for dual point chain or cable hanging (std.)
- Advanced and Basic Controls Options
- -40°F-131°F Ambient Temperature Range
- 3000K-5000K CCT
- Uplight Options
- >80 Color Rendering Index (CRI)
- Calculated L70 >100,000 hrs
- 0-10V Dimmable Driver (100%-10%)
- 120-277V Universal Voltage
- 5 Year Warranty (std); 10 Year Warranty Optional
- ETL Listed for Damp Location
- DesignLights Consortium® Qualified Luminaire



Fixtures shown with Frosted Lens (FRL)

SUITABLE APPLICATIONS

- Gymnasiums •Manufacturing Plants •Warehouses •Distribution Centers

ORDERING GUIDE:

SERIES	LUMENS (select one)		DRIVER	CCT	LENS OPTIONS		DISTRIBUTION		UPLIGHT		FINISH		WARRANTY
EDV	8L ²⁰	30L	U 120-277V	50	BLANK	No Lens	BLANK	Wide	BLANK	No Uplight	BLANK	White	BLANK 5 Year
Endeavour	12L	36L		40	FRL	Frosted Acrylic	ND	Narrow	UP/2L ^{1,2}	2000lm Uplight	BLK ^{1,7}	Black	10YR ¹⁶ 10 Year
	15L	48L		35	PFL	Frosted			UP/4L ^{1,3}	4000lm Uplight	C ^{1,10}	Custom	
	18L	60L		30		Polycarbonate							
	24L												



OPTIONS		CONTROLS OPTIONS ¹	
Factory Installed		Basic	
Cx/3W	3-wire cord standard fixtures (xFT = Length; x=6,10,15,20)	FIOS ^{8,11}	On/Off Occupancy Sensor
Cx/3W/L7-15P	Cord (x=ft) with 277V 15amp Plug (x= 6,10,15,20)	FIOSPC ^{8,11}	On/Off Occupancy Sensor w/ Photocell
Cx/4W	4-wire cord for EM fixtures (xFT = Length; x=6,10,15,20)	FIOSPC/DLH ^{9,12}	On/Off Occupancy Sensor w/ Daylight Harvesting
Cx/5W	5-wire cord for non EM fixtures with external dim control (xFT = Length; x=6,10,15,20)	DHPC ^{8,11}	Daylight Harvesting
Cx/6W	6-wire cord for EM fixtures with external dim control (xFT = Length; x=6,10,15,20)	USBD ^{8,11}	User Bi-Level Dim Sensor w/ Occ. Sensor
QDx/3W	3-wire Quick Connect standard fixtures (xFT = Length; x=6,10,15,20)	BDxx ^{8,11}	Preset Bi-Level Dim Sensor (xx=%eg.20,30)
QDx/4W	4-wire Quick Connect for EM fixtures (xFT = Length; x=6,10,15,20)	BDxxPC ^{8,11}	Preset Bi-level Dim Sensor w/ Photocell
QDx/5W	5-wire Quick Connect for non EM fixtures with external dim control (xFT = Length; x=6,10,15,20)	CLOS	Cold Location Occupancy Sensor
QDx/6W	6-wire Quick Connect for EM fixtures with external dim control (xFT = Length; x=6,10,15,20)		
GTD	Factory Installed Generator Transfer Device		
EM5 ¹³	5W LED Factory Installed Battery Backup		
EM5/HE ¹³	5W LED Factory Installed Battery Backup - CEC Title 20 Compliant		
EM7 ¹³	7W LED Factory Installed Battery Backup		
EM7/HE ¹³	7W LED Factory Installed Battery Backup - CEC Title 20 Compliant		
EM10 ¹³	10W LED Factory Installed Battery Backup		
EM10/HE ¹³	10W LED Factory Installed Battery Backup - CEC Title 20 Compliant		
EM10/HE/SD ¹³	10W Factory Installed Self Diagnostic Battery Backup		
EM12 ¹³	12W LED Factory Installed Battery Backup		
EM20 ^{4,5,13}	20W LED Factory Installed Battery Backup - CEC Title 20 Compliant		
EM25 ^{4,5,13}	25W LED Factory Installed Battery Backup		
SD480 ¹	480V Step Down Transformer		
SD347 ¹	347V Step Down Transformer		

¹ Refer to DLC for listing ² Easily Controlled via Mobile Phone with Philips MasterConnect Bluetooth App ³ Available for EDV-8L-24L only ⁴ Cannot be used w/ FMB, HUB, or HOOK ⁵ Mounted externally to fixture ⁶ Sensor Mounted off end cap of fixture ⁷ Reduces published performance by 16% ⁸ Sensor Mounted on center driver channel ⁹ Consult Factory ¹⁰ Operation down to 14°F ¹¹ Operation down to -22°F ¹² Operation down to 32°F ¹³ Must use w/ FMB/EDV for Pendant Mounting ¹⁴ Must use w/ HUB 3/4 for Pendant Mounting ¹⁵ Must use w/ FMB/EDV for Pendant Mounting ¹⁶ Operation down to -4F ¹⁷ Contact Factory for more details ¹⁸ Does Not Qualify for DLC ¹⁹ Contact Factory for Site Layout ²⁰ Center Mounted Sensor

ENDEAVOUR

LINEAR HIGH BAY

Ship With Accessories		Advanced	
WC ¹⁷	11 GA Wire Cage	ESMC/HB ^{6,8,12}	EasySense High Bay Sensor
FMB/EDV ¹⁴	Fixture Mounting Box	FSP311L2 ⁹	Legrand FSP-311 Bluetooth Programming Sensor – 8' Mounting Height
HUB 3/4 ¹⁵	Conduit Hub 3/4" for pendant mount	FSP311L3 ⁹	Legrand FSP-311 Bluetooth Programming Sensor – 20' Mounting Height
HOOK	Cast Iron Hook for single point mounting	FSP311L7 ⁹	Legrand FSP-311 Bluetooth Programming Sensor – 40' Mounting Height
ACxY	Adjustable Y-Toggle aircraft cable set (x = 5' or 10')		
SMZBKIT/EDV	Surface Mount Bracket	5S/CU/CL ^{9,13}	Enlighted 5E Connected Lighting (CL) Sensor with Control Unit
		5S/CU/IOT ^{9,13}	Enlighted 5E Internet of Things (IOT) Sensor with Control Unit
ESMC/WWS/DR	EasySense Dual Rocker Wireless Wall Switch	SYN ¹⁸	Synapse Control System
		SYNS/LX ^{18,19}	Synapse Control System w/ Sensor (X = Mounting Height 3=10-20, 7=20-40)

¹ Refer to DLC for listing ⁶ Easily Controlled via Mobile Phone with Philips MasterConnect Bluetooth App ¹⁰ Consult Factory ¹⁵ Must use w/ FMB/EDV for Pendant Mounting ²⁰ Operation down to -4F
² Available for EDV-8L-24L only ⁷ Reduces published performance by 16% ¹¹ Operation down to 14°F ¹⁶ Contact Factory for more details
³ Available for EDV-30L-60L only ⁸ Sensor Mounted off end cap of fixture ¹² Operation down to -22°F ¹⁷ Does Not Qualify for DLC
⁴ Cannot be used w/ FMB, HUB, or HOOK ⁹ Sensor Mounted on center driver channel ¹³ Operation down to 32°F ¹⁸ Contact Factory for Site Layout
⁵ Mounted externally to fixture ¹⁴ Must use w/ HUB 3/4 for Pendant Mounting ¹⁹ Center Mounted Sensor



QUICK SHIP ITEMS:

SERIES	LUMENS	DRIVER	CCT	PRIMARY LENS
EDV Endeavour	12L 18L 24L	U 120-277V	50 40	FRL* Frosted Acrylic Lens

* Stocked products only available with Frosted Lens (FRL)

SPECIFICATIONS

CONSTRUCTION

Aluminum body with steel driver channel for maximum rigidity and thermal properties. Sleek curved polycarbonate injection molded end caps provide a modern finish while adding rigidity and durability. Toolless hinged driver door access for ease of maintenance and installation. Power access plate mounted on back of center driver channel for easy access to wiring. Product proudly assembled in the United States of America.

ELECTRICAL

Class 2 LED light engine for high efficacy and long life. Calculated $L_{70} > 100,000$ hrs. LED Lumen Maintenance Estimates based on TM-21 projections for the light source at 25°C ambient. Power Factor > 0.90 . Standard 120-277 Vac 0-10V dimmable (10%-100%) with optional 347-480 Vac step down transformer. Optional emergency battery backups and generator transfer device available to meet critical life safety lighting requirements. Fixture reduced maximum ambient for emergency battery backup and step down options. Optional uplight wired to sensor it ordered together.

MOUNTING

Options include suspension chain, aircraft cables, hook, single pendant (HUB), surface mount (SMZBKIT). Reduced maximum ambient range for surface mount.

UPLIGHT OPTION

Offers an additional layer of lighting to optimize full room illumination by reducing the contrast between the luminaire and the ceiling, eliminating the “cave” effect. With a dedicated individual switchable 0-10V (10%) dimmable driver and 2 linear strips of LED boards, the modules are encapsulated with a frosted polycarbonate lens and are sealed to an IP5X rating.

OPTICS

Standard without lens. Optional frosted acrylic (FRL) and frosted polycarbonate (PFL) lenses available for added LED protection and glare reduction. Both optics are IP5X rated; protected against dust intrusion. Frosted Polycarbonate lens (PFL) is IK10 Impact Rated; highest impact rating available. Wide (std.) & Narrow (ND) Distribution options available for all lumen packages.

THERMAL

Ambient temperature range -40F up to 131F (-40C to 55C). Reference LED Systems Info for more detail. Fixture to be mounted at a minimum plenum height of 18" to maintain maximum ambient temperature. Reduced maximum ambient for surface mounting.

CONTROLS

Factory installed Advanced and Basic integral occupancy sensor options available. All Basic sensors are end mounted. Advanced EasySense sensor is end mounted. All other Advanced sensors are center driver cover mounted. Inquire with manufacturer for additional controls options, including customer supplied items.

CERTIFICATIONS

ETL listed to US and Canadian safety standards. Suitable for damp locations. American Recovery and Reinvestment Act Funding Compliant. Please refer to the DLC (DesignLights Consortium) Qualified Products List at www.designlights.org/QPL to confirm specific product qualifications.

WARRANTY

5 Year Warranty Standard; 10 Year Warranty Optional ([Terms and Conditions apply](#)).

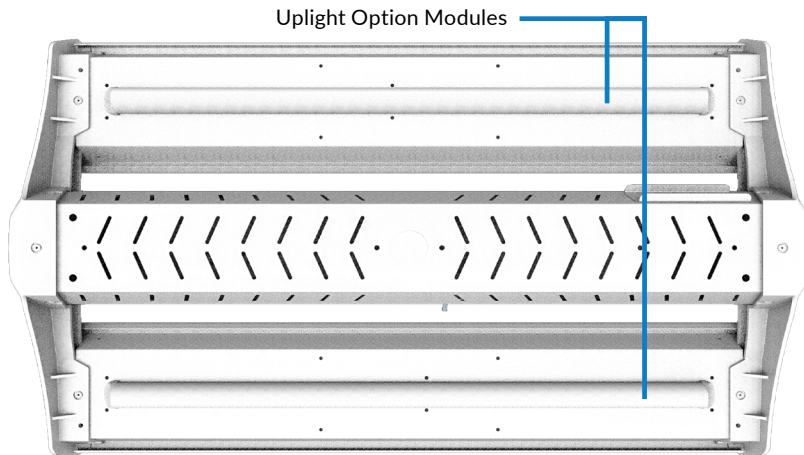

CONTROLS OPTIONS

BASIC

FIOS

Standard on/off motion sensor. Comes with 360 degree high bay lens, 360 degree low bay lens & aisle lens. 360 degree high bay lens factory installed, unless notified otherwise. Sensor mounted off end cap of fixture. Inquire for mounting on center of driver cover.

FIOSPC

Motion sensor with the addition of photocell control. When installed, fixture will not activate unless 1. motion is detected and 2. light levels are below the preset level. When activated, fixture will turn on to 100% light output & will only shut off when one of the two levels mentioned above are met. If no motion is detected & light levels fall below preset level the fixture remains off. Sensor mounted off end cap of fixture.

FIOSPC/DLH

Factory installed motion sensor with the addition of photocell control that will allow for daylight harvesting. When installed, fixture will not activate unless 1. motion is detected & 2. light levels are below the preset level. When activated, fixture will turn on only enough to meet the preset light levels and will adjust as the amount of light in the space adjusts between 100%-10%. If light levels are adequate the fixture will remain off. Sensor mounted off end cap of fixture.

ADVANCED

Philips ESMC/HB

EasySense sensor combines occupancy sensing, daylight harvesting and institutional tuning in one compact solution. This is an ideal control for any high bay application. Each device allows you to turn on/off occupancy and/or daylight harvesting functions as well as set the full light output, background light level, occupancy prolong time, occupancy grace fading time & occupancy time out/hold time. Easily Controlled via Mobile Phone with Philips MasterConnect Bluetooth App. (Sold separately). Sensor mounted off end cap of fixture.

Synapse

Utilizing a robust 2.4 GHz Self-Healing Mesh Network, Synapse provides flexibility and scalability making it a perfect industrial solution for both new construction and retrofit projects. The easy-to-use web application is accessible on any device with an internet connection and allows for complete customization of the system and its features. Integral radio (SYN) includes (2) 24V inputs for a Wattstopper sensor. Sensors available in 20' or 40' mounting lenses. Sensor mounted on hinged driver cover. Antenna exits side of luminaire for maximum connectivity.

USBD

User Selectable Bi-Level Dimming. Allows the end user to manually select the unoccupied dimming level. Once motion is detected, the fixture will return to 100% light output. Sensor mounted off end cap of fixture.

BDxx

Factory set Bi-Level Dimming. Sensor is set to dim level, as indicated in the "xx" portion of the part number, when the area is unoccupied. Example: BD20 sets the fixture to dim down to 20% lumen output when the area is unoccupied. Once motion is detected, the fixture will return to 100% light output. Sensor mounted off end cap of fixture.

BDxxPC

Factory set Bi-Level Dimming with motion and photocell. Sensor is set to dim level, as indicated in the "xx" portion of the part number, when the area is unoccupied and will not return to 100% light output unless 1. motion is detected and 2. the light level is below the preset level. Example: BD20PC sets the fixture to dim down to 20% lumen output when the area is unoccupied and will not return to 100% light output unless the above conditions are met for both motion and light level readings. Sensor mounted off end cap of fixture.

DHPC

Daylight Harvesting off photocell. Fixtures will continually dim up/down throughout the day based on light level readings taken from the photocell control. Sensor mounted off end cap of fixture.

Legrand FSP-311

FSP-311 offers fully adjustable high and low dimmed light levels with optional photocell. Hold off setpoint with automatic calibration option. Adjustable time delay and cut off delay. Sensor adjustable programming via iOS® or Android® 'Sensor Configuration' App. Sensor mounted on center driver channel.

Enlighted 5S/CU/CL

Bundled System with Enlighted Sensor. Fixtures are controlled based on occupancy & ambient light. Includes individual lighting control plus connection to Enlighted Energy Manager. The Energy Manager provides data analysis for all data collected by the Enlighted Smart Sensors for energy, occupancy & environment. Provided factory installed components only. Enlighted system provided by others. Contact factory for more information. Sensor mounted on center driver channel.

Enlighted 5S/CU/IOT

Bundled System with Enlighted Sensor. Fixtures are controlled based on occupancy and ambient light. Includes individual lighting control plus connection to Enlighted Energy Manager. The Energy Manager provides data analysis for all data collected by Enlighted Smart Sensors for energy, occupancy & environment. Additionally, the IOT functionality takes the data access and function beyond just lighting to a wide range of applications beyond the standard connected lighting controls. Provided factory installed components only. Enlighted system provided by others. Contact factory for more information. Sensor mounted on center driver channel.

ENDEAVOUR

LINEAR HIGH BAY

OPTIONS



Cx/yW

Cords - (x = 6, 10, 15, 20 (ft)) (y = conductors; 3, 4, 5, 6) Plug options available



QDx/yW

Quick Disconnect - (x = 6, 10, 15, 20 (ft)) (y = conductors; 3, 4, 5, 6)

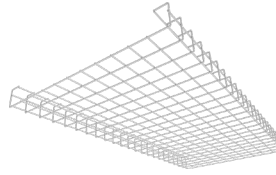

WC

11 GA Wire Cage

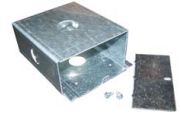

FMB

Includes rigid box to attach to the fixture, provides for single point mounting to accept a pendant, hook or conduit hub (sold separately)



HUB 3/4

Conduit Hub 3/4" for Pendant Mounting



HOOK

Cast Iron Hook for Single Point Mounting



ACxY

Includes 2 adjustable cable hangers. Available in 5' or 10'



SMBZKIT

Surface Mount Bracket Kit provides a 2" space above the fixture

LINE DRAWINGS

8L - 24L

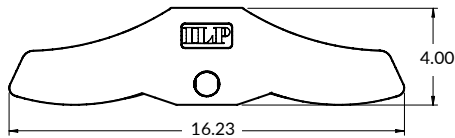
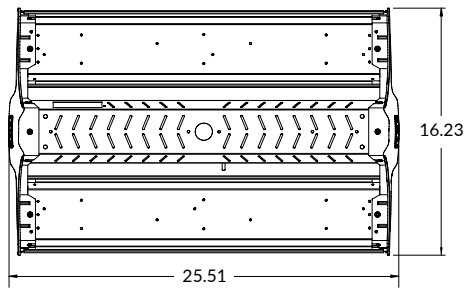

30L

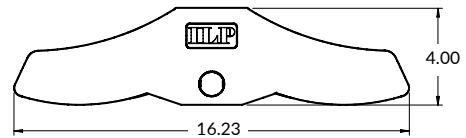
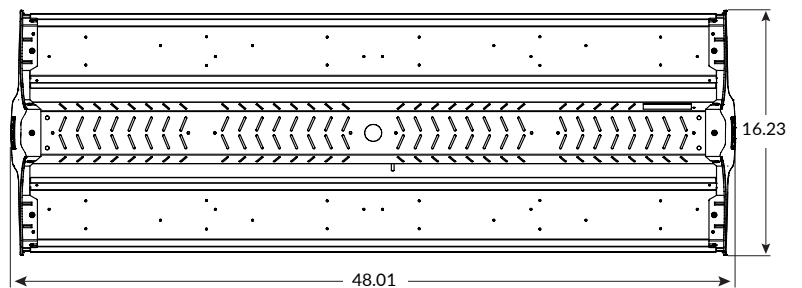

36L - 60L

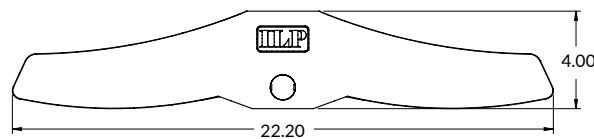
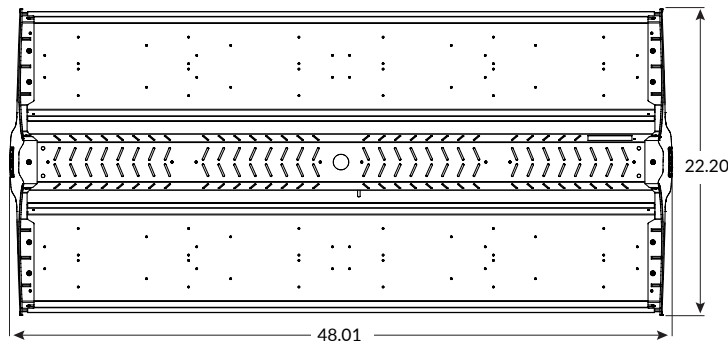

LINEAR HIGH BAY

PHOTOMETRIC DATA

LUMINAIRE DATA	
Part Number	EDV-24L-U-50
Description	Endeavour 2ft High Bay, 24000lm, without lens
Fixture Lumens (lm)	24,950 lm
Wattage (W)	164 W
Efficacy (lm/W)	152 lm/W
Mounting	Pendant
Spacing Criteria	0° = 1.27, 90° = 1.29

ZONAL LUMEN SUMMARY		
Zone	Lumens (lm)	% Fixture
0° - 40°	11,878	48%
0° - 60°	20,932	84%
0° - 90°	24,950	100%
90° - 180°	0	0%
0° - 180°	24,950	100%

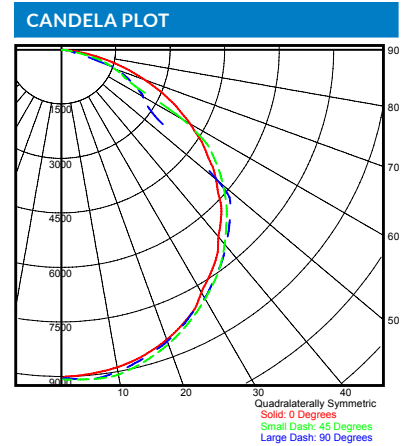

LUMINAIRE DATA	
Part Number	EDV-24L-U-50-FRL
Description	Endeavour 2ft High Bay, 24000lm, with frosted acrylic lens
Fixture Lumens (lm)	23,600 lm
Wattage (W)	163 W
Efficacy (lm/W)	145 lm/W
Mounting	Pendant
Spacing Criteria	0° = 1.24, 90° = 1.24

ZONAL LUMEN SUMMARY		
Zone	Lumens (lm)	% Fixture
0° - 40°	11,452	49%
0° - 60°	19,284	82%
0° - 90°	23,600	100%
90° - 180°	0	0%
0° - 180°	23,600	100%

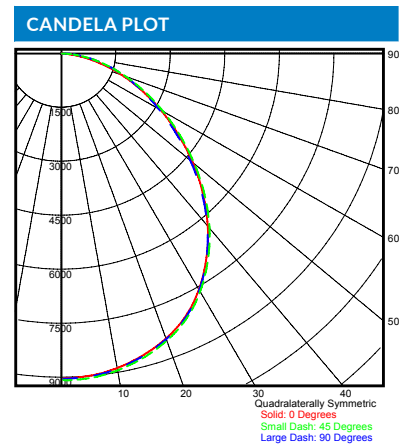

LUMINAIRE DATA	
Part Number	EDV-24L-U-50-FRL-UP/2L
Description	Endeavour 2ft High Bay, 24000lm, w/ frosted acrylic lens & 2000lm upright
Fixture Lumens (lm)	25,600 lm
Wattage (W)	176 W
Efficacy (lm/W)	145 lm/W
Mounting	Pendant
Spacing Criteria	0° = 1.24, 90° = 1.24

ZONAL LUMEN SUMMARY		
Zone	Lumens (lm)	% Fixture
0° - 40°	11,452	45%
0° - 60°	19,284	75%
0° - 90°	23,600	92%
90° - 180°	2,000	8%
0° - 180°	25,600	100%

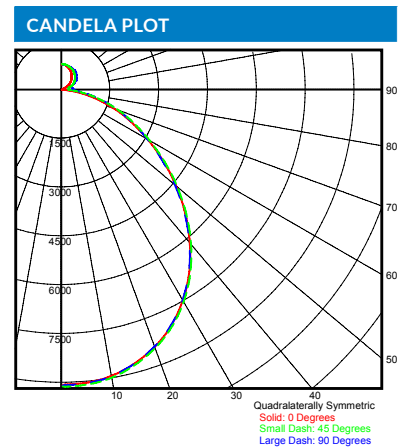

LUMINAIRE DATA	
Part Number	EDV-24L-U-50-FRL-ND
Description	Endeavour 2ft High Bay, 24000lm, with narrow distribution through a frosted acrylic lens
Fixture Lumens (lm)	21,780 lm
Wattage (W)	163 W
Efficacy (lm/W)	134 lm/W
Mounting	Pendant
Spacing Criteria	0 = 1.14 90 = 0.82

ZONAL LUMEN SUMMARY		
Zone	Lumens (lm)	% Fixture
0° - 40°	12,945	59.5%
0° - 60°	18,909	86.8%
0° - 90°	21,780	100%
90° - 180°	0	0%
0° - 180°	21,780	100%

