



# SQUARE CANOPY

LED CANOPY & PARKING GARAGE







## SAVINGS MADE EASY

The Square Canopy series is the ideal solution for replacing existing canopy or parking garage luminaires from CFL to 250W Metal Halide. Square Canopy's energy efficient design results in energy savings up to 85% with prices that allow customers to quickly meet their financial payback thresholds.

Serving a broad range of applications from parking structures to pavilions, the versatile Square Canopy series provides a seamless retrofit solution with its 10" wide housing designed to cover most existing housing footprints.

## OPTIONS YOU WANT

Optional Microwave Sensor provides 360° motion detection discretely installed behind the lens keeping the fixture's clean, slim profile design.

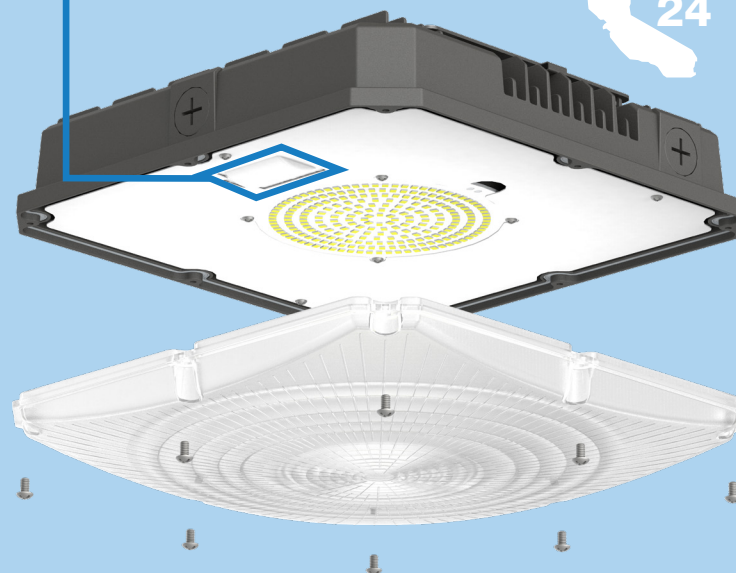

## DISTRIBUTIONS

The standard Prismatic diffuse Medium lens eliminates glare and optimizes the delivered light for visually comfortable illumination that creates a smooth, uniform distribution.

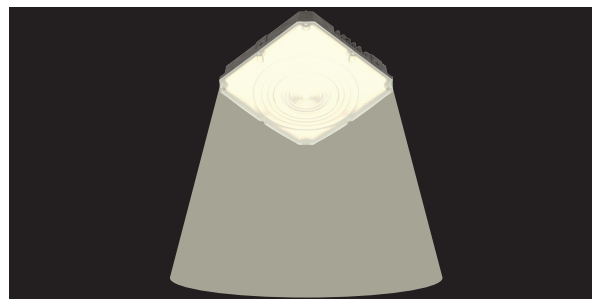

The Prismatic Wide Lens was designed specifically for parking garage applications to maximize fixture spacing and reduce fixture counts for the maximum return on investment.

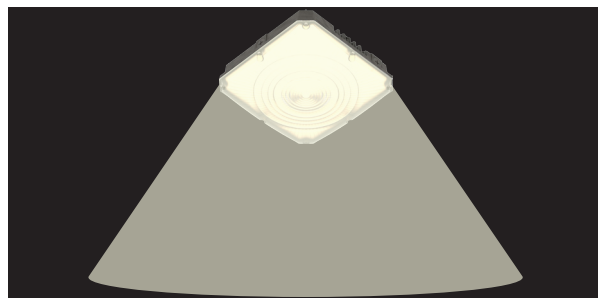

## DIMENSIONS

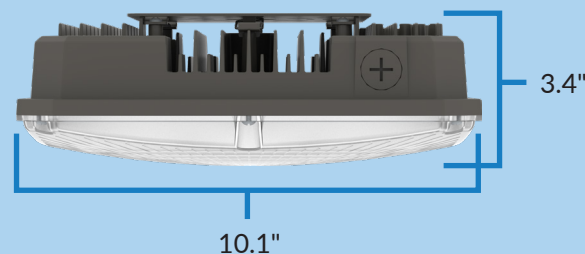

## FEATURES YOU NEED

Rugged Low-Profile Die-Cast Aluminum Housing

Three ½" coin plugs for surface mount conduit or universal electronic photocell

Superior Thermal Management

IP65 Rated Luminaire

3 lumen packages delivering up to 129 lm/W

0-10V Dimmable to 10%

Minimum 80 CRI

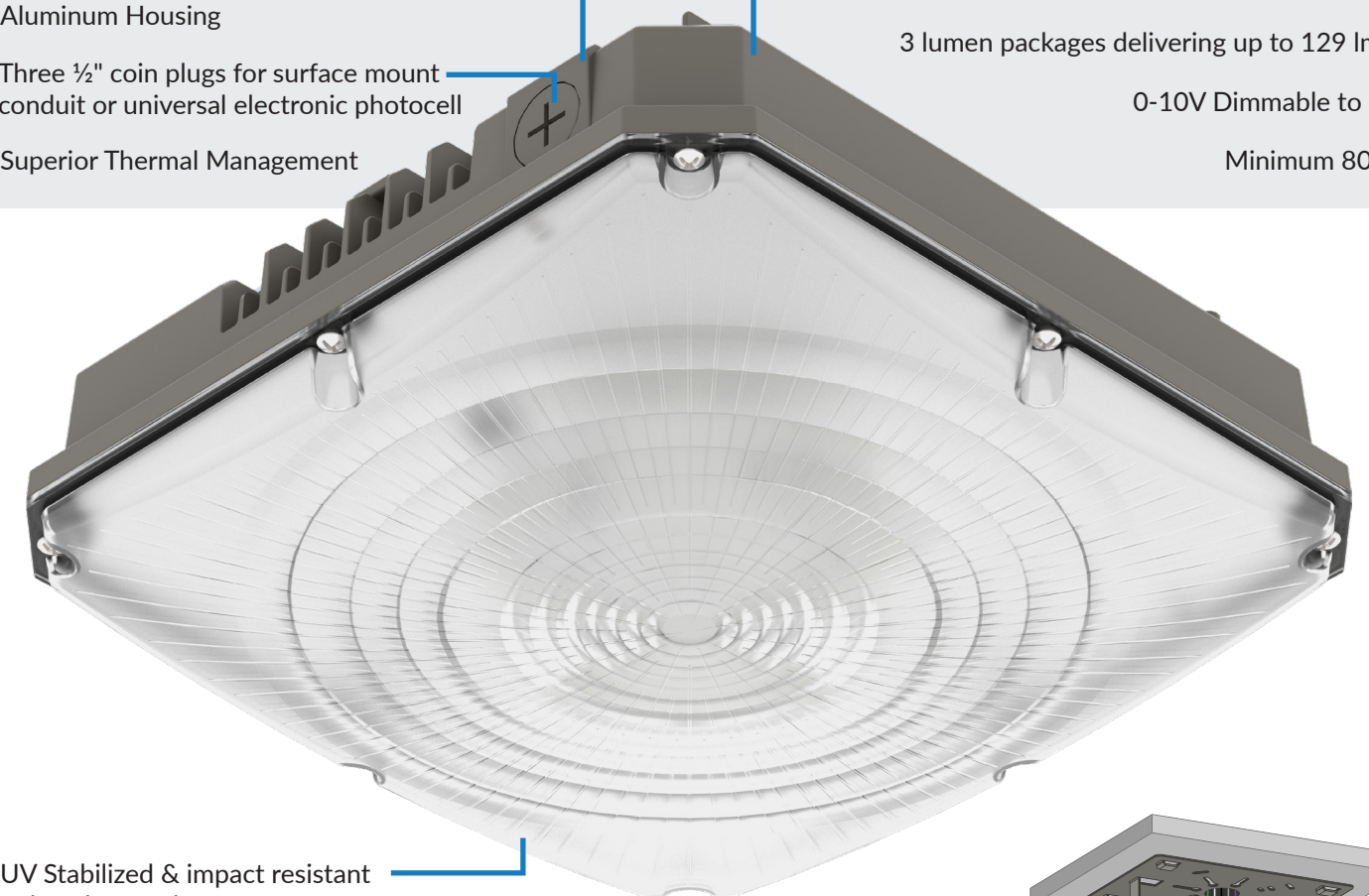

UV Stabilized & impact resistant polycarbonate lenses

Diffuse lens eliminates glare for maximum visual comfort

Up to 3% uplight eliminates cave effect

120-277V Universal Voltage or 347-480V High Voltage

Installs via ¾" conduit or quick surface mount bracket, eliminating the need to open the luminaire during installation, allowing for labor savings up to 50%.

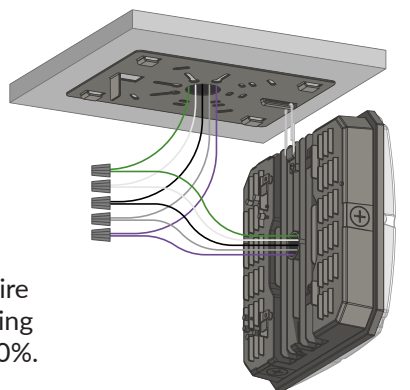

## LED SYSTEMS INFO

PART NUMBERS	LENS	LUMENS	EFFICACY	WATTS <sup>2</sup>	DLC LISTING	REPLACES
CP-3L	BLANK (Medium)	3,450 lm	123 lm/W	28W	Premium	100W
CP-5L	BLANK (Medium)	5,090 lm	127 lm/W	40W	Premium	150W
CP-7L	BLANK (Medium)	7,328 lm	124 lm/W	59W	Premium	175W
CP-9L	BLANK (Medium)	8,192 lm	124 lm/W	66W	Premium	250W
CP-3L	PG (Wide)	3,819 lm	136 lm/W	28W	Premium	100W
CP-5L	PG (Wide)	5,093 lm	127 lm/W	40W	Premium	150W
CP-7L	PG (Wide)	7,602 lm	129 lm/W	59W	Premium	175W
CP-9L	PG (Wide)	8,455 lm	128 lm/W	66W	Premium	250W





"Your Number One Source  
For Energy Efficient Lighting"

407-478-3759  
[WWW.ILP-INC.COM](http://WWW.ILP-INC.COM)